

VIDEO SPECIFICATIONS

- Total Hanging Weight: 905 lbs
- 32 Video Cabinets
- Cabinet dimensions: 640mm x 640mm x 90mm
- Display size: 16'-9 5/8" x 8'-4 3/4"
- Resolution: 1280x640
- Pixel Pitch: 4mm

ELECTRICAL REQUIREMENTS

- 240V-40amp single phase circuit

COMMUNICATIONS REQUIREMENTS

- Category 6 Cable can be installed from video display to operators' station if distance is less than 300 ft
- If distance to operators' station is greater than 300 ft, fiber will need to be installed to operators station

INSTALLATION KIT

The installation kit includes the following:

- Wall template for mounting J-Channel
- (8) J-Channel mounting rails
- (40) 3/8 Titen masonry fasteners
- (24) M10-1.5 x 20mm bolt
- (14) 6' CAT 5 ethernet patch cable
- (14) Power adapter female to female
- (1) 16' 6" Power cord male to disconnect

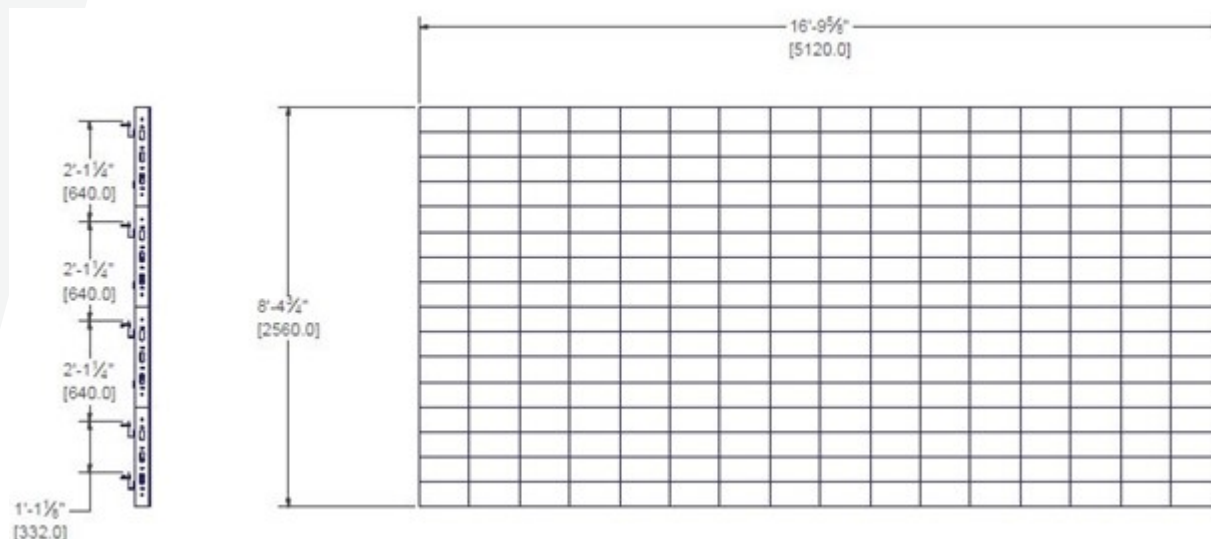

RECOMMENDED DISPLAY INSTALLATION TOOLS

- Impact Drill
- Hammer Drill
- 3/16" Masonry drill bit
- 3/8" Masonry drill bit
- 9/16 Wrench
- 16mm socket
- 9/16 socket driver
- 5/16 socket driver
- Masking tape
- Measuring tape
- 4' level
- Duck Bill Metal Bender Tool



VIDEO DISPLAY INSTALLATION:

1. Tape the wall template to the wall at the display installation location.



2. Make sure the template is level
3. Identify which template diagram measurements match your display
4. Use the template guides to locate and drill the starter holes for each J-channel
5. Use the wall template to drill the 3/8" holes for the J-channel

6. Ensure the J-channel is level, using the titen fasteners, attach the J-channels to the wall



1. Repeat this step for each J-channel H
2. Hang the video cabinets onto the J-channel

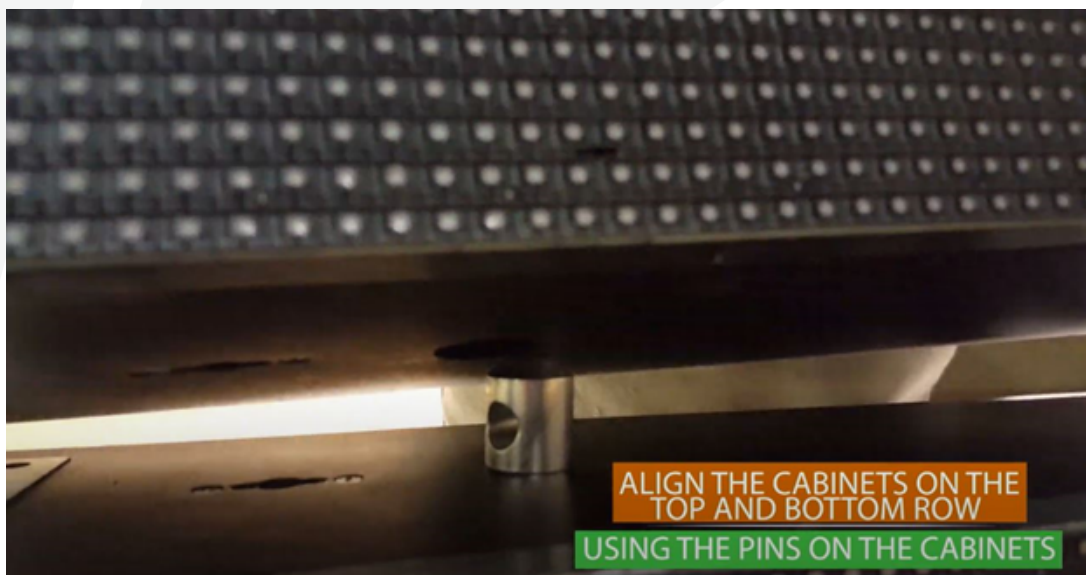

3. Remove the magnetic tiles to gain access to the inner cabinet connections
4. Use the supplied 10mm bolts to tighten each cabinet to the next

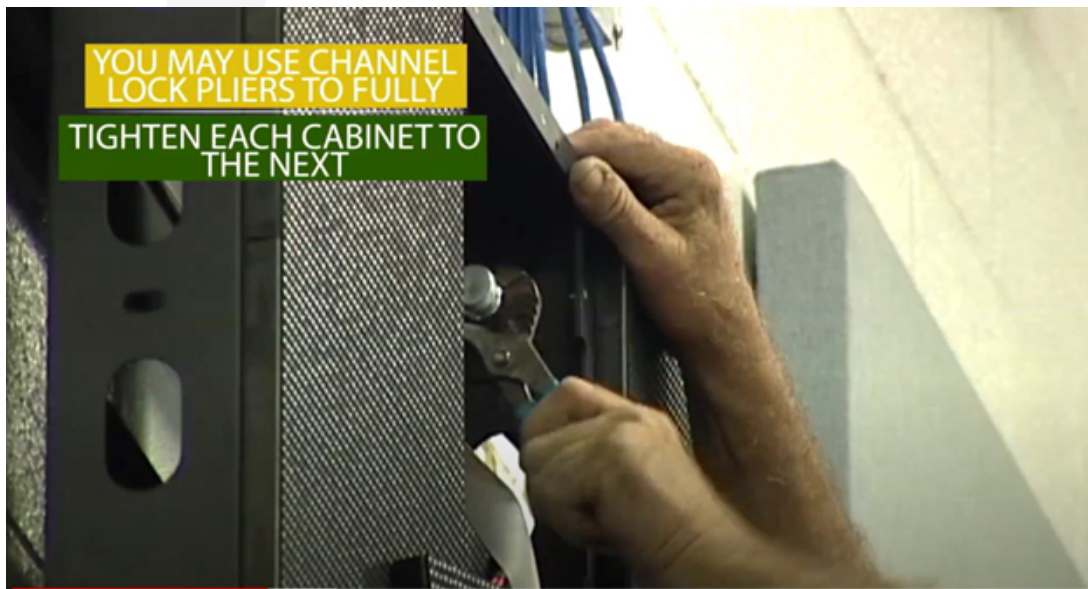

5. Following the wiring diagram, use the supplied female to female power adapters to complete the video power circuits

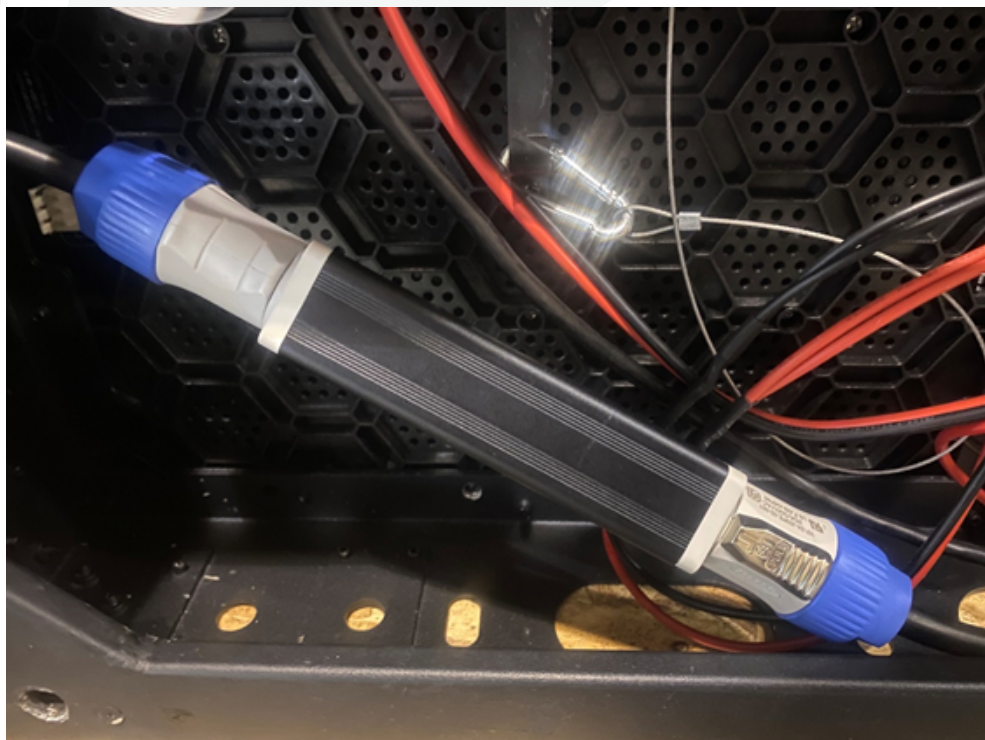

6. Starting at the bottom right cabinet, and following the wiring diagram use the supplied ethernet patch cables to connect each cabinets video feed

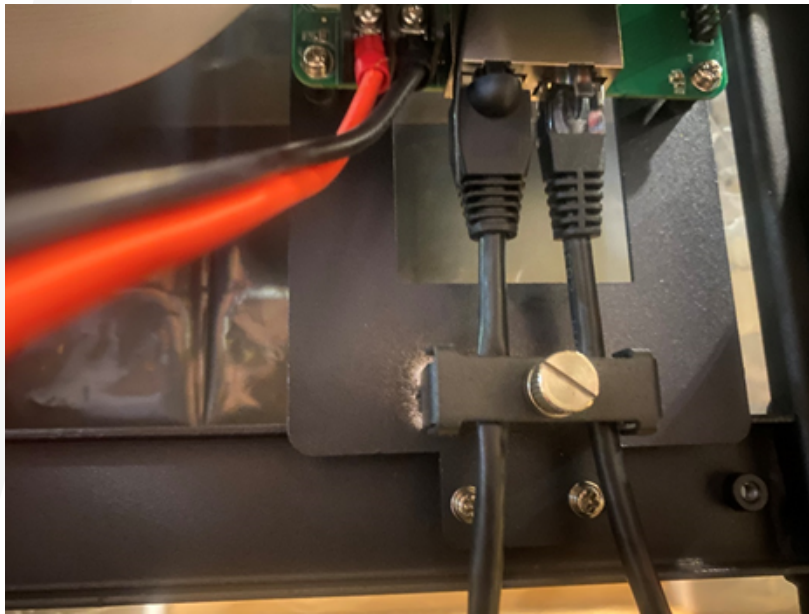

7. Using the provided 16'-6" male to disconnect power cord, wire to local power disconnect from the bottom right cabinet

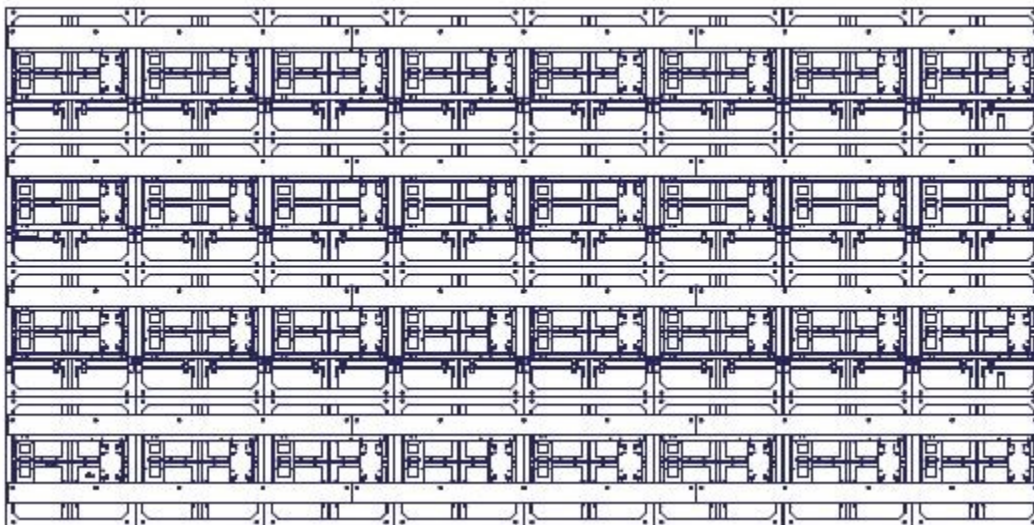

8840 Rear View showing J-channel Layout)

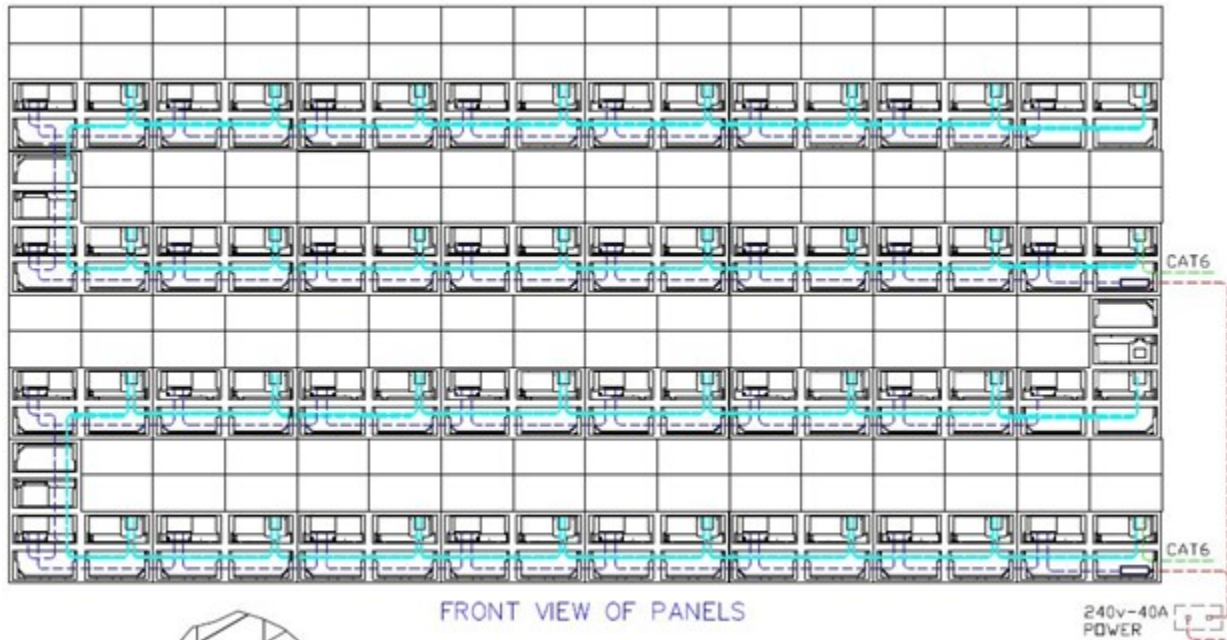

(8840 Wiring Diagram)

SPONSOR PANELS

1. Fasten the mounting brackets to each sponsor panel, hand tighten only



2. Use the duck bill metal bender tool to insure the panel edges are at a 90 degree angle to the face
3. Begin attaching the sponsor panels using the supplied self drilling screws. Drilling through the video cabinet and into the sponsor panel. Start on the bottom of the display



4. If installing the surrounding sponsor panels option, the two bottom sponsor panels should be centered in the middle of the display (if installing the single top or bottom sponsor panel, this will be one section)
5. Clamp the two sponsor panels together along the vertical joint
6. Fasten the sponsor panels to each other using the self drilling screws



7. Drill 3/16" holes into the wall for the sponsor panel wall brackets and fasten with masonry anchors



8. Tighten the bolts on the sponsor panel wall brackets

9. If installing the surrounding sponsor panels option, attach the side sponsor panels to the sides of the video display

10. If installing the surrounding sponsor panels option, attach the top sponsor panels to the top of the display, centering the top two sponsor panels above the display

ADDITIONAL IMAGES

8840 Top or Bottom Sponsor Panel Option

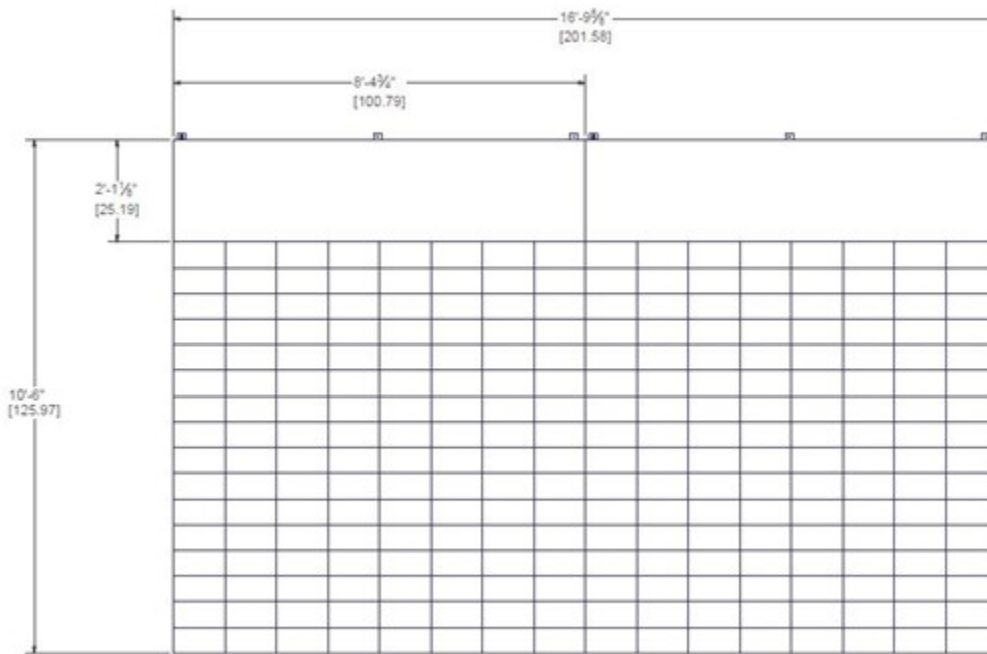

8840 Surrounding Sponsor Panels Option

